

Drawing Name: 3. V. 81000-0100A.000 - Lawrence Hospital - Lillibridge Site Plan - 1st Floor - 8/25/2011
 Drawing No.: 81000-0100A.000 - 1st Floor - 8/25/2011
 Date Printed: Aug 25, 2011, 8:11am

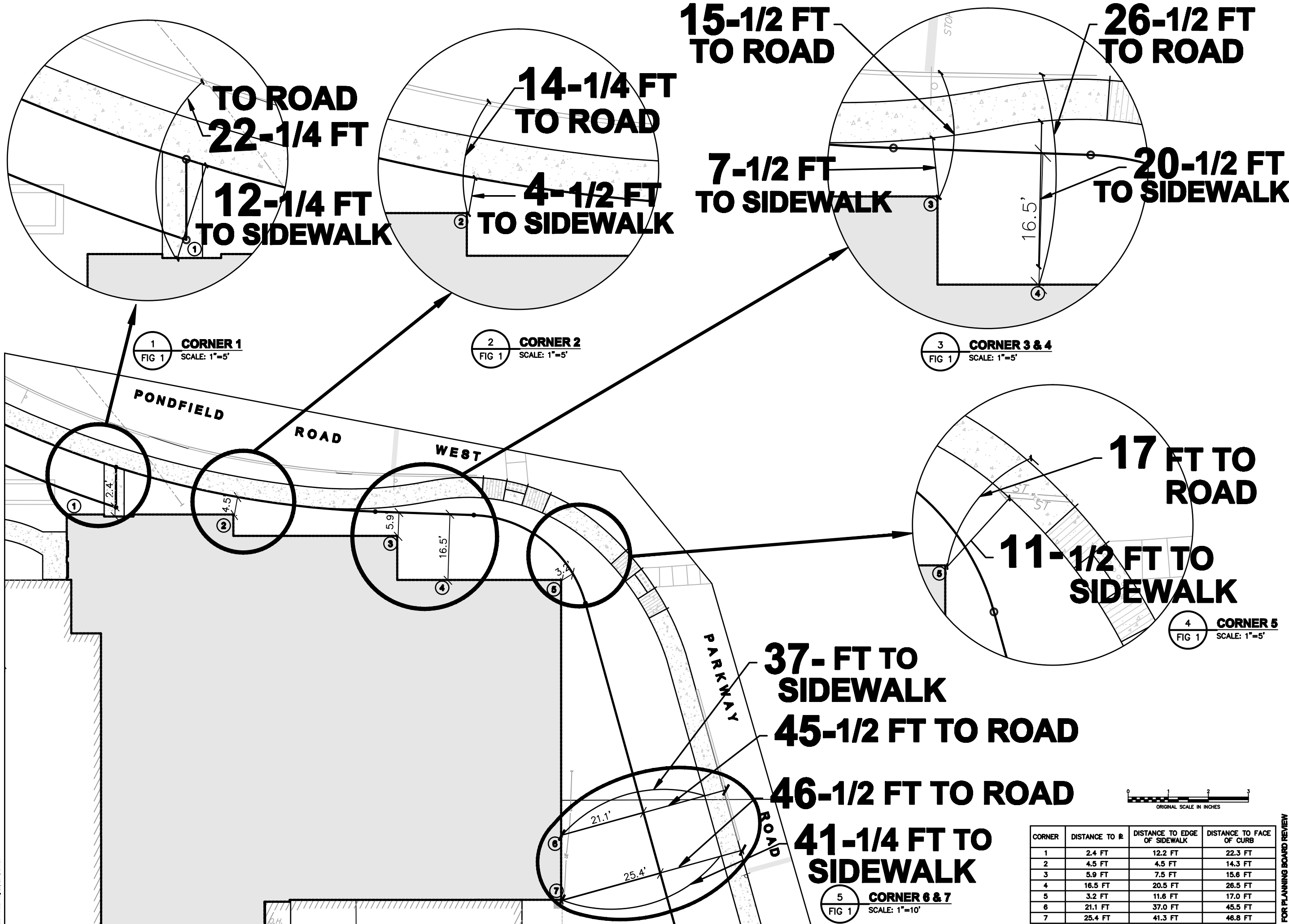

1 CORNER 1
FIG 1 SCALE: 1"=5'

2 CORNER 2
FIG 1 SCALE: 1"=5'

3 CORNER 3 & 4
FIG 1 SCALE: 1"=5'

4 CORNER 5
FIG 1 SCALE: 1"=5'

5 CORNER 6 & 7
FIG 1 SCALE: 1"=10'

CORNER	DISTANCE TO #	DISTANCE TO EDGE OF SIDEWALK	DISTANCE TO FACE OF CURB
1	2.4 FT	12.2 FT	22.3 FT
2	4.5 FT	4.5 FT	14.3 FT
3	5.9 FT	7.5 FT	15.6 FT
4	16.5 FT	20.5 FT	26.5 FT
5	3.2 FT	11.6 FT	17.0 FT
6	21.1 FT	37.0 FT	45.5 FT
7	25.4 FT	41.3 FT	48.8 FT

FOR PLANNING BOARD REVIEW

REVISIONS	NO.	DATE	BY	GC
	1	8/25/2011		

PROJECT NO: 2009-09
 DATE: 08/18/2011
 DRAWN BY: SOMM/GC
 SHEET NO.

EXHIBIT A

THIS DOCUMENT IS THE PROPERTY OF LHS FACILITIES DEVELOPMENT GROUP INC. & SHALL NOT BE USED WITHOUT LHS FACILITIES DEVELOPMENT GROUP INC. EXPRESS WRITTEN CONSENT

LAWRENCE HOSPITAL CENTER
CANCER CENTER & OPERATING ROOM RELOCATION
 55 PALMER AVENUE
 BRONXVILLE, NY 10708

THE CHAZEN COMPANIES
 ENGINEERS/ARCHITECTS
 LANDSCAPE ARCHITECTS

LILLIBRIDGE™
 A VENTAS COMPANY